

VingCard's Elevator Controller is designed to be built into the elevator panel and operates offline.



Simple installation

The elevator control unit is sophisticated, yet easy to install, and functions with magnetic stripe keycards.

Compatibility

Fully compatible for use with VingCard 3000 single and multi-user systems and VingCard 2100 (software version 1.3 and greater).

Off-line verification

VingCard's elevator controller permits off-line verification through access bitmap technology, which eliminates the need for wired connection to a central verifier. Up to 7 outputs enable call buttons to be selectively activated, so that access to floors is limited to each guest or staff keycard privileges.

Simple operation

Simple operation - all valid floor buttons light up and remain active for 10 seconds after a valid card is inserted into the elevator reader.

Finish

The elevator controller is available in the same finishes as the VingCard locks.

Quality

The elevator controller is both designed by and produced at VingCard's factory in Norway. This is your guarantee of quality.



Features

- :: A complete stand alone card locking system.
- :: All guests use keycards. Easily replaceable at a fraction of the cost of metal keys.
- :: No wiring
- :: No batteries
- :: No computer
- :: High quality brass escutcheon reinforced by a steel plate for added security. Solid brass handles.
- :: Full mortise ANSI or EURO lock case, with a security latch and a strong dead bolt.
- :: Recodable cylinder for staff.
- :: Recoded in seconds by exchanging a code card in the inner compartment.
- :: 3-hours UL fire rating.

Elevator Controller

Complete Elevator Controller

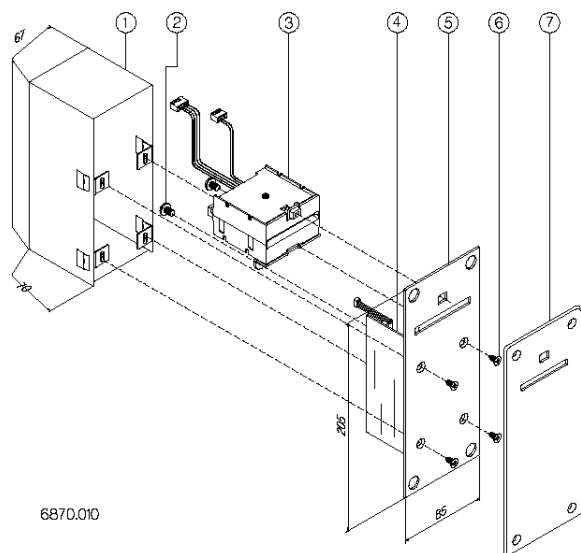

6870.010

Dimension

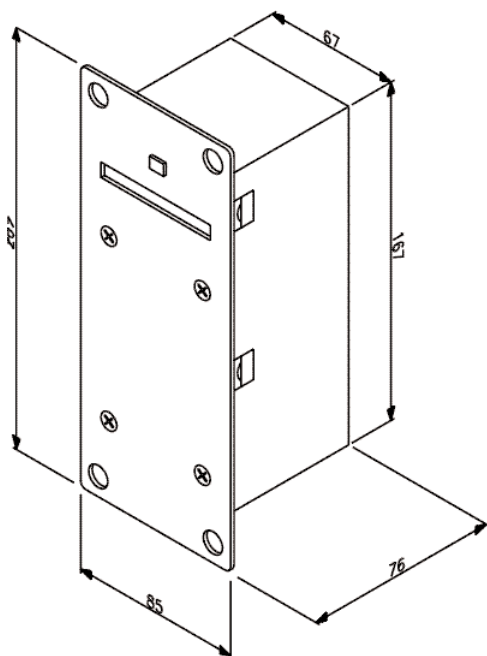

Specification may be changed without notice

Each complete unit, supplied individually packed, consists of:

- z Box.
- ı Screws 5x8mm for mounting LCU (Lock Control Unit) to steel plate.
- < LCU.
- > Main circuit board.
- Steel plate.
- † Screws for mounting steel plate to box.
- ‡ Front escutcheon.

Dimensions:	Flush mounted model
Height:	207mm
Width:	85mm
Depth:	76mm

Input voltage:	24VDC +/- 20%
Current:	15mA

The 7 outputs:

Outputs 1-6 are low current:

Max current	1A
Min current	1mA
Max voltage	30VDC
Min voltage	10 mV

Output 7 is for high voltage:

Max current	5A
Min current	10mA
Max voltage	30VDC
Min voltage	5VDC

NOTE: Specify finish when ordering.
Specifications may change without notice.